



tavelrealtgroup.com



988 N MITTHOEFFER RD | INDIANAPOLIS, IN

- Corner location.
- Nearly 40,000 vehicles per day.
- Average household income \$65,731.
- 3750 sf end cap unit available.
- Former Immediate Care Center.
Complete with x-ray & exam rooms.
- Perfect for medically related use.
- Subdivisible.

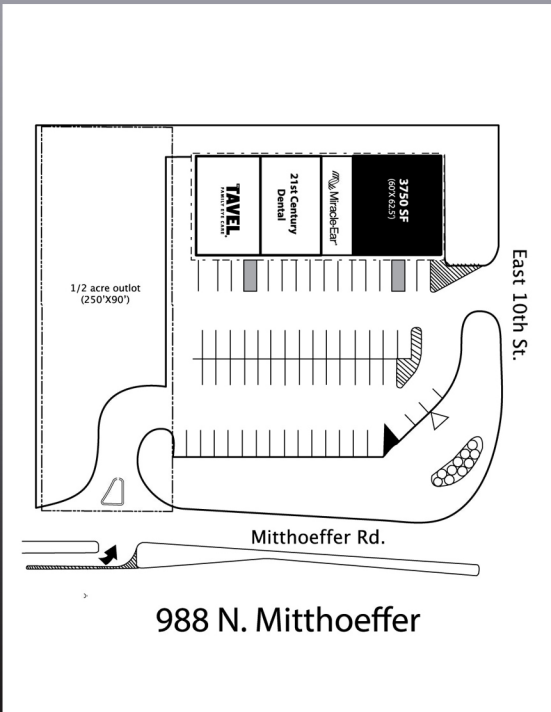

DEMOGRAPHICS

Distance	Est. Population	Est. Household Income
2 Mile Radius	31,487	\$65,731
3 Mile Radius	57,934	\$59,062

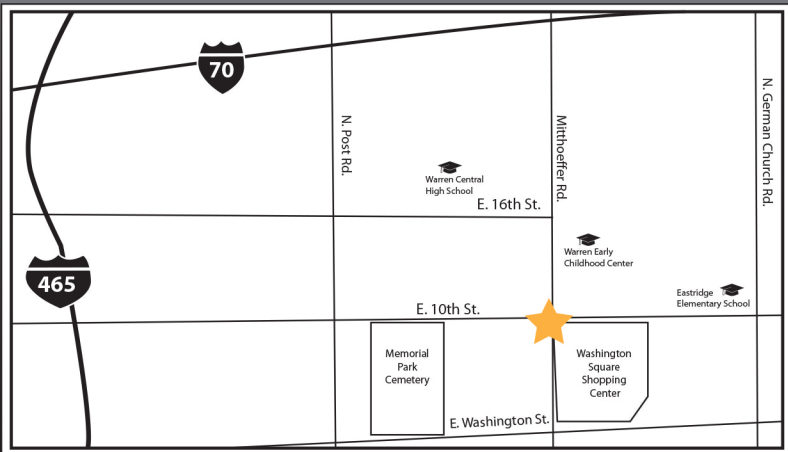

988 N. Mitthoeffer

East 10th St.

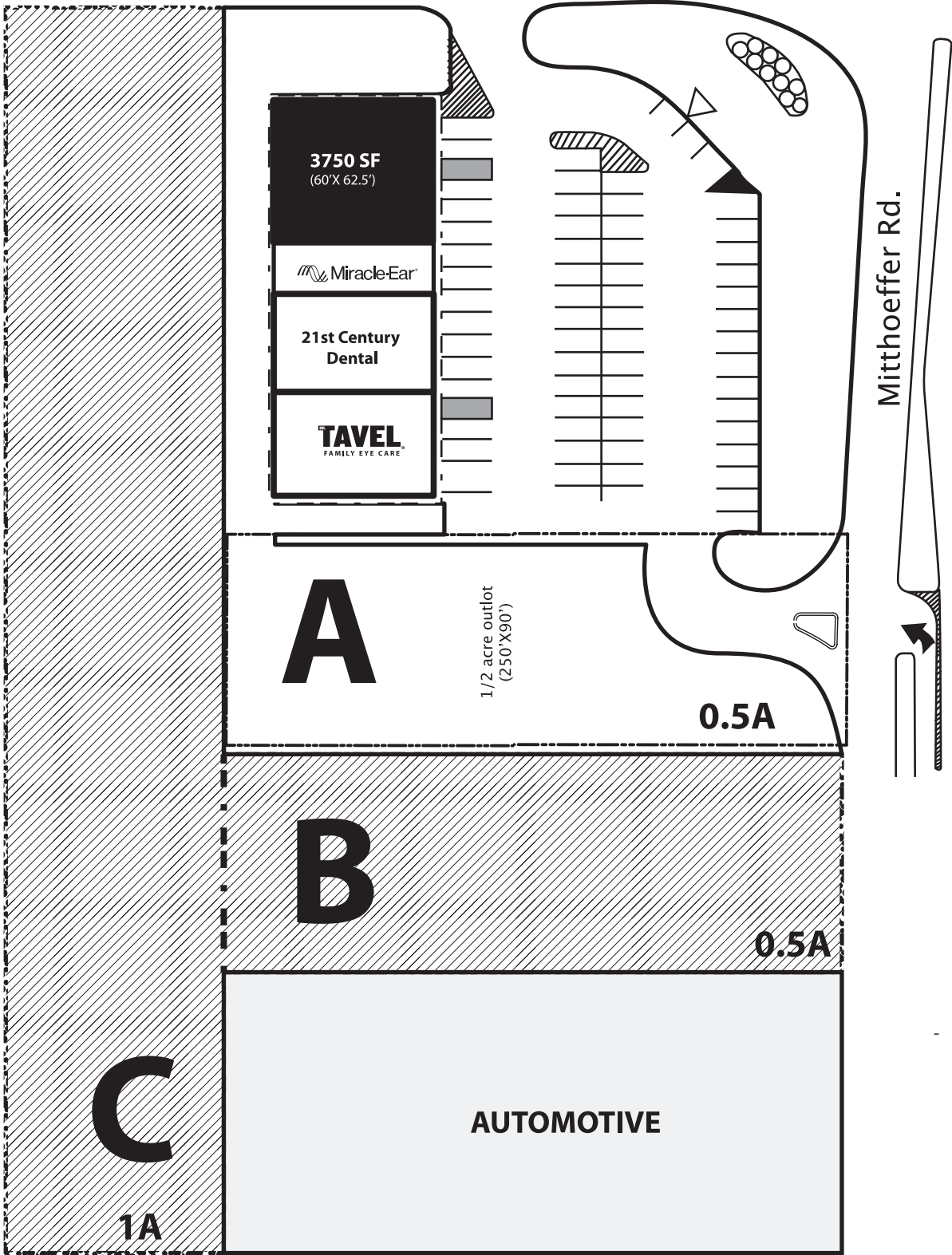

CURRENTLY AVAILABLE

1/2 ACRE: A

POTENTIAL AQUISITION

1 ACRE: A+B

2 ACRE: A+B+C

